

FAG

**20212-K-TVP-C3**

Barrel roller bearing

Schaeffler ID:  
0384287170030

Barrel roller bearing 202...-K-TVP

## Technical information

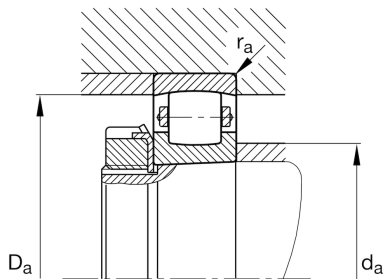
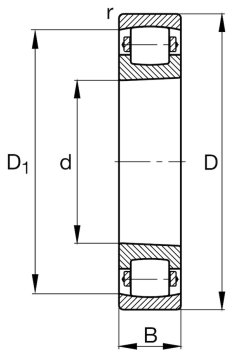
**Main Dimensions & Performance Data**

d	60 mm	Bore diameter
D	110 mm	Outside diameter
B	22 mm	Width
$C_r$	85,000 N	Basic dynamic load rating, radial
$C_{0r}$	100,000 N	Basic static load rating, radial
$C_{ur}$	11,000 N	Fatigue load limit, radial
$n_G$	6,600 1/min	Limiting speed
	0.796 kg	Weight

**Dimensions**

$r_{min}$	1.5 mm	Minimum chamfer dimension
$D_1$	97.8 mm	Bore diameter outer ring

**Mounting dimensions**

$d_{a min}$	69 mm	Minimum diameter shaft shoulder
$D_{a max}$	101 mm	Maximum diameter of housing shoulder
$r_{a max}$	1.5 mm	Maximum recess radius
$d_{a max}$	73 mm	Maximum diameter of shaft shoulder
$d_{b min}$	64 mm	Minimum cavity diameter of the sleeve
$B_{a min}$	6 mm	Minimum cavity width of the sleeve

**Additional information**

H212	Adapter sleeve
------	----------------

**Temperature range**

$T_{min}$	-30 °C	Operating temperature min.
$T_{max}$	120 °C	Operating temperature max.